

SMART INDOOR CAMERA

WHITE FINISH

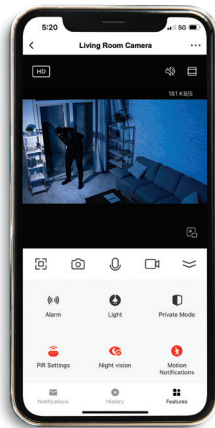

STARFISH
live life enlightened



**SIMPLE PLUG & PLAY
INSTALLATION**

**REMOTE VIEWING AND
TWO-WAY TALK**

**LIVE AND EVENT HISTORY
MONITORING**

**EXPANDABLE MICRO SD
CARD STORAGE**

Easily expand home security with SATCO|NUVO's Indoor Smart Camera. Mount to the ceiling or wall to view any indoor space. View in real-time, or playback motion activated events from anywhere on your mobile device with the STARFISH® app. Discreetly listen in or actively engage in conversation with the two-way talk feature. Best of all, no subscription fees, ever.

This camera is also compatible with Google Home, Siri, SmartThings, and Alexa, including the Alexa Show.

**NO MONTHLY
SUBSCRIPTION**

STARFISH® ENABLED PRODUCT

- Night Vision
- Remote Access
- Multi-User
- AWS Secure

WIFI
2.4GHz
No Hub Required



GENERAL SPECIFICATIONS

WiFi Frequency: 2.4GHz
Camera Resolution: 1080p
Field of View: 93° Diagonal
Local Storage:
 32GB SD Card Included (Expandable up to 128GB)
Finish: White

Operating Temperature:
 -20°C (-4°F) to +45°C (+113°F)
Installation: Includes double-sided mounting tape for fixed placement, Ceiling or Wall application.
Power: USB-C Cable and Plug-In adapter (included)
Warranty: 1 Year

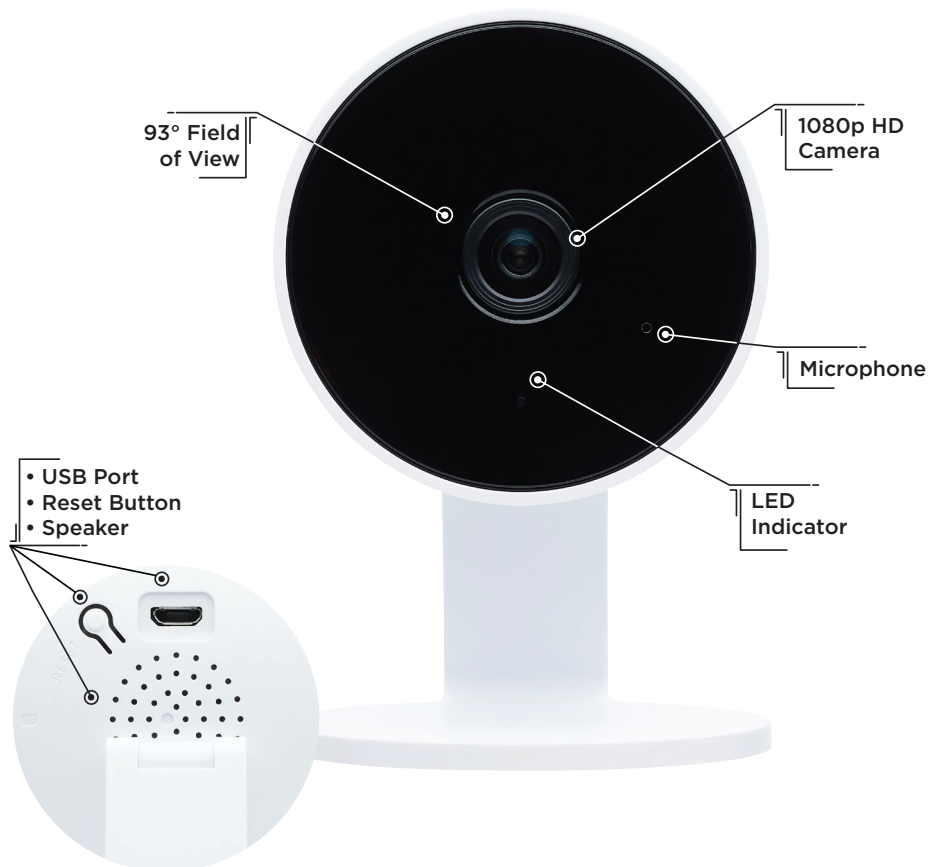

DOWNLOAD THE STARFISH APP



CONNECT
 Download the STARFISH® app

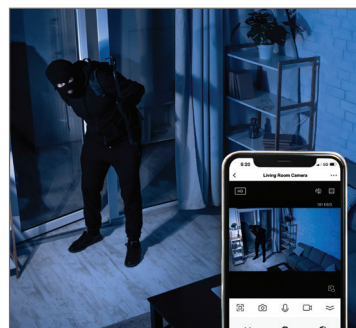

INSTALL
 Pair and configure your settings



ENJOY
 The convenience and customization of smart lighting

This device complies with Part 15 of the FCC Rules. Operation is subject to the following two conditions: (1) this device may not cause harmful interference, and (2) this device must accept any interference received, including interference that may cause undesired operation.

WARNING: Some products included in this specification sheet may be subject to the warning requirements of California's Proposition 65. Please refer to your product packaging for more information.

Amazon, Alexa and all related logos are trademarks of Amazon.com, Inc. and its affiliates. Siri is a registered trademark of Apple Inc. Google, Google Play and Google Home are trademarks of Google LLC.

Visit satco.com/service/warranty for complete warranty details.



ITEM SPECIFICATIONS/ORDERING INFO

Item	Finish	Width (A)	Height (B)	Extends (C)	Weight
65-940	White	3.58"	3.58"	2.64"	0.13 Lbs.

